

AIR AWNING SET UP

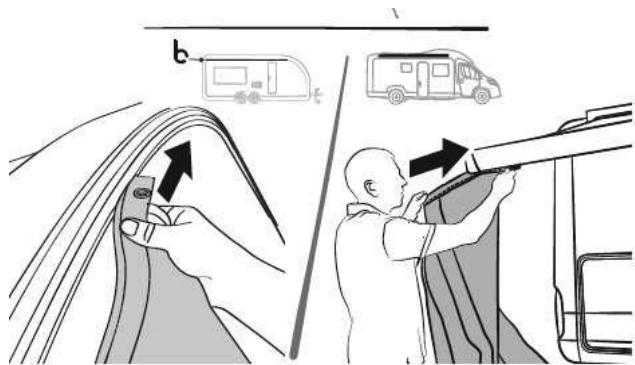

CONNECTING AWNING TO VEHICLE

- Use two people, one to thread and other to pull awning through the channel. May need to stand on a ladder/chair to thread
- Rally AIR Pro Range is supplied with two keders 5mm and 7mm
- Thread the awning keder into the awning channel of the vehicle as per pic and use the 7mm keder for Caravans
- May connect to the channel of a box awning on RV's. Unwind box awning slightly to expose the lead-rail as per pic, thread using the 5mm keder for box awnings
- Pull awning through awning channel until awning is centred along the straight rail with coverage over the entrance door
- Wind back box awning to closed position

AIR AWNING SET UP

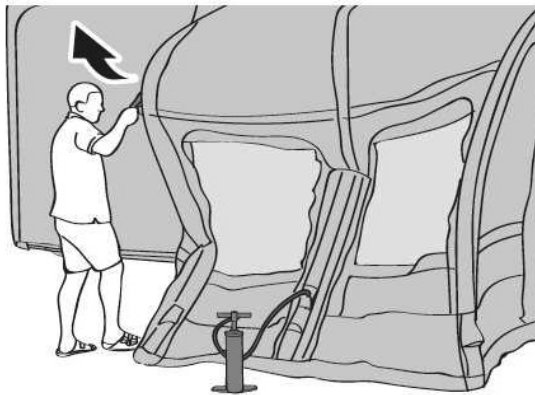
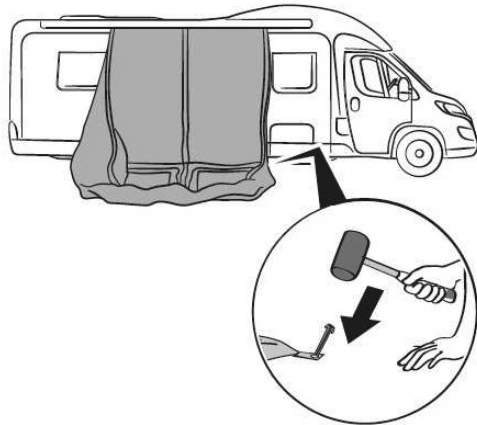

AWNING FITTED TO STRAIGHT RAIL

- Straighten out awning and peg down corners
- Ensure all zips and windows are closed
- Ensure deflation valves are closed
- Ensure isolation valves are open
- Insert nozzle into the inflation valve and inflate awning to recommended pressure (9psi for RAP)
- Secure remaining pegs and tension tie down straps to ground awning securely
- Make final adjustments to Multi Height System
- Ensure Apex air vents are open

AIR AWNING SET UP

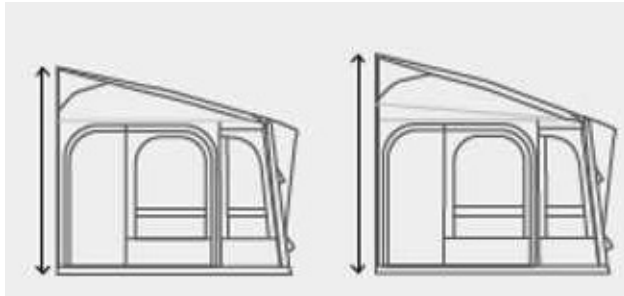

MULTI HEIGHT SYSTEM PATENT PENDING

- This unique Dometic feature enables the Dometic Awnings to be set up on uneven ground
- Offers up to 15cm of extra height
- Left and Right sides may be adjusted independently
- Performs better in adverse weather by effectively shedding rainwater and fitting closer to the vehicle wall

HOW DOES IT WORK

- Simply unzip the gusseted side panels on outside and inside walls
- Peg down the skirt
- Close zip on outside and inside walls to a point to hide excess material

AIR AWNING EXTENSION SET-UP

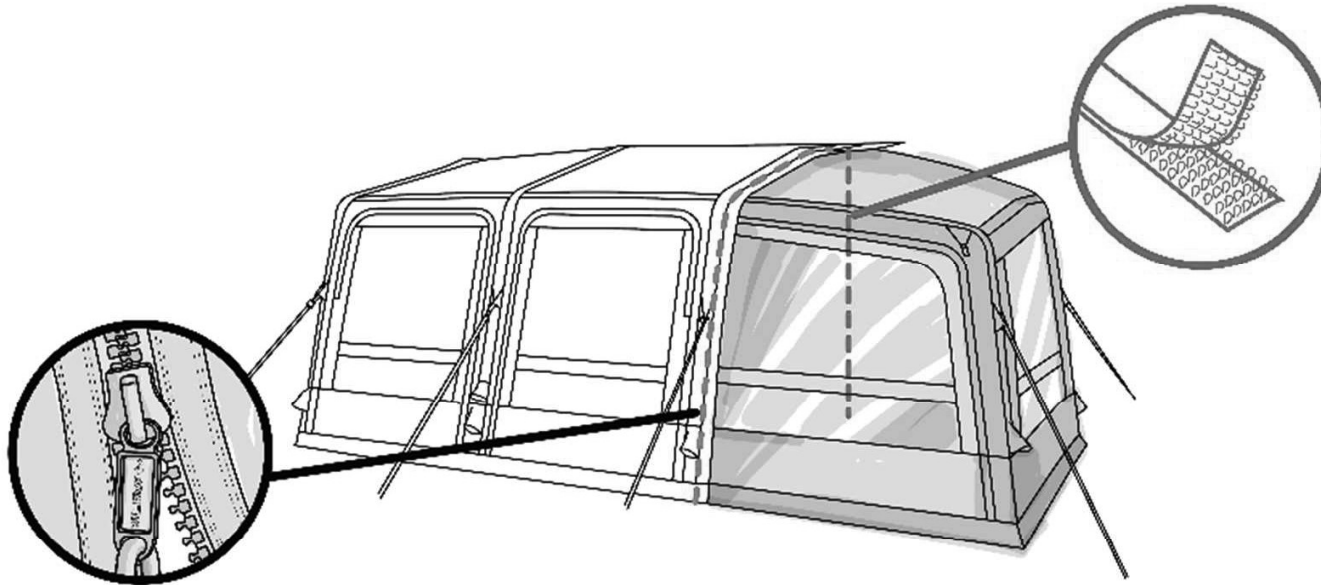

Quick And Easy Set-up

- Awning to be fully set-up first
- Zip and attach the extension from the front pegging point to the vehicle
- Join the Velcro strip to the awning
- Ensure all doors and windows are fully closed before inflation
- Peg and fasten down